

Please make sure to read the enclosed Ninja® Owner's Guide prior to using your unit.

NINJA PERFECT CLEAN TECHNOLOGY

All you need is a little maintenance and you'll enjoy delicious coffee, mug after mug.

CLEAN CYCLE - Will take  **8 minutes** to complete.



1. CLEAN light illuminates on the unit.

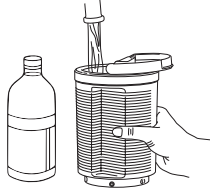

2. Fill reservoir to Max Fill line with descaling solution* and water or white vinegar** and water.

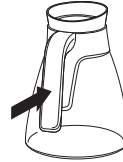

3. Place empty carafe under brew basket.



4. Select Full Carafe size.



5. Press CLEAN button. Countdown will begin on clock display.

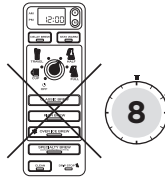

6. During 8-minute Clean Cycle, do not press any buttons. Unit may dim.

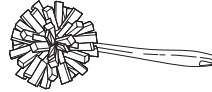

7. Empty and clean carafe and reservoir.†



8. CLEAN light will turn off when complete.

RECOMMENDED:

Flush your system by running two more clean cycles with water only.



*Descaling solution is available from ninjakitchen.com. Follow your solution's recommended concentration level.

**Fill the water reservoir to the Travel Mug line (16 oz.) with white vinegar, then add water to Max Fill line.

†CAUTION: Do not immerse coffeemaker in any liquid.

4-digit Date Code (located on plug prong): First two number between 00-25, last number "16", or anything ending with "15".